

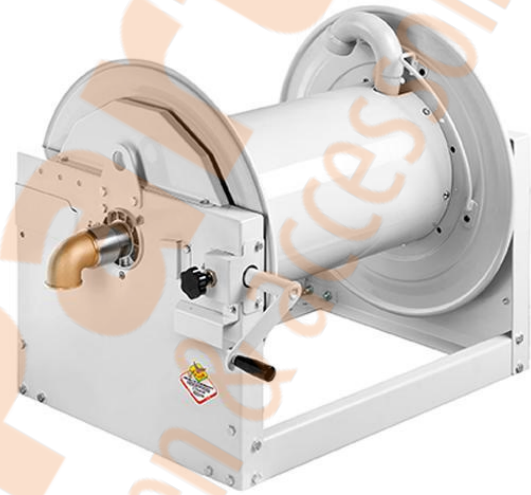

ART. 7771001.100

Manual hose reels - s. 700

Manual hose reel, s.700, for air-water and diesel, 20 bar, without hose. Drum width 690 mm. Inlet-outlet G 2" (f)



FLUIDS

FRESH OIL | AIR | WATER | DIESEL FUEL

SECTORS

RAILWAY TRANSPORT | MANUFACTURING INDUSTRY | MINING | SHIPPING AND OFFSHORE

Features	UM	Value
Pressure	bar	20
Compatible fluids		air - water - diesel fuel
Swivel joint		aluminum
Seals		Viton®
Characteristic		manual
Material		painted steel
Couplings		-
Hose		-
Ø and hose length	Ø - m	-
Inlet		G 2" (f)
Outlet		G 2" (f)
Reel flow path		aluminum - zinc plated steel
Internal drum width	mm	680

RAASM SpA

via Marangoni 33, 36022 - S. Zeno di Cassola (VI) - ITALIA
Tel. 0039 0424 571111 - Fax. 0039 0424 571135

info@raasm.com - www.raasm.com

Copyright © 2020 All rights reserved to RAASM S.p.A.



Overall dimensions

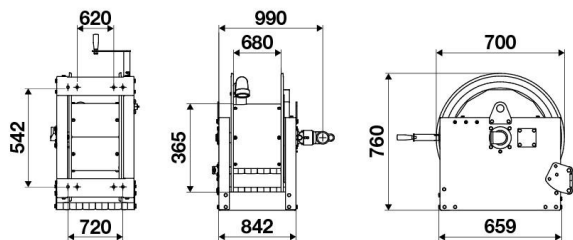

Altec Parts
hagedrukonderdelen & accessoires

RAASM SpA

via Marangoni 33, 36022 - S. Zeno di Cassola (VI) - ITALIA
Tel. 0039 0424 571111 - Fax. 0039 0424 571135

info@raasm.com - www.raasm.com

Copyright © 2020 All rights reserved to RAASM S.p.A.