

- ✓ Polished stainless steel
- ✓ Maintenance free
- ✓ Sealed stainless steel ball bearings
- ✓ High flow, low torque



Application

Pharmaceutical industry, food industry, high flow, low rpm, automatic car wash systems

TECHNICAL DATA

Pressure 350 bar (35 MPa)
200 bar* (20 MPa)

Temperature 120°C

RPM max. 30 rpm

Body stainless steel

Inner part Seal stainless steel
O-ring NBR
(optional: EPDM or FKM)

Bearing 1x thrust ball bearing
2x sliding bearings

Throughput medium pH 3 - 12
10 µm filtered
20 bar compressed air

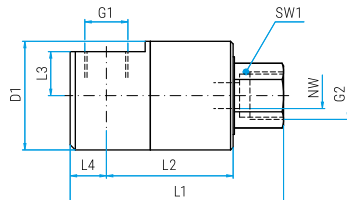
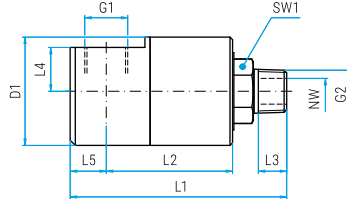
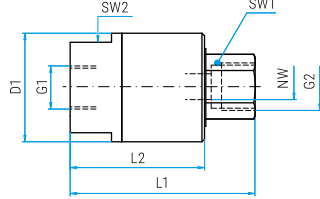
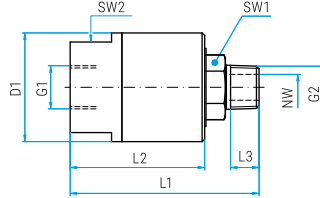
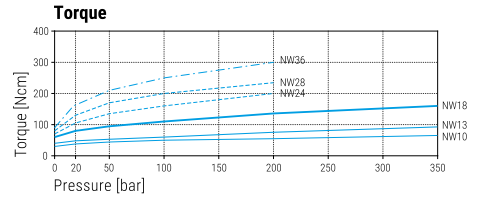
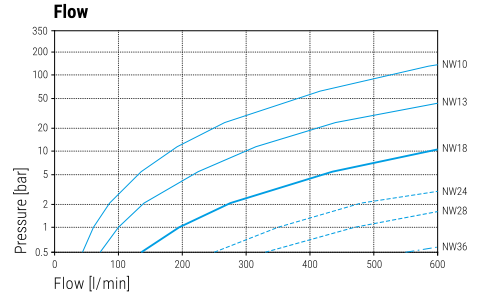

DGEI

Part No.	G1 (F)	G2 (M)	NW	SW1	SW2	L1	L2	L3	D1	Weight
34.702	G3/8" F	R3/8" M	10	22	35	73	52	11	42	540 g
34.703	G1/2" F	R1/2" M	13	22	35	80	55	15	42	540 g
34.704	G3/4" F	R3/4" M	18	27	40	93	65.5	16	50	790 g
34.705*	G1" F	R1" M	24	36	50	95	65	18	60	1140 g
34.706*	G1 1/4" F	R1 1/4" M	28	38	50	115	76	20	60	1350 g
34.707*	G1 1/2" F	R1 1/2" M	36	50	70	117	78	20	85	2680 g

Part No.	G1 (F)	G2 (F)	NW	SW1	SW2	L1	L2	D1	Weight
34.712	G3/8" F	G3/8" F	10	22	35	71	52	42	530 g
34.713	G1/2" F	G1/2" F	13	27	35	80	55	42	570 g
34.714	G3/4" F	G3/4" F	18	32	40	93	65.5	50	820 g
34.715*	G1" F	G1" F	24	36	50	90	65	60	1130 g
34.716*	G1 1/4" F	G1 1/4" F	28	50	50	108	76	60	1410 g
34.717*	G1 1/2" F	G1 1/2" F	36	54	70	110.5	78	85	2640 g

DGEI 90°

Part No.	G1 (F)	G2 (M)	NW	SW1	L1	L2	L3	L4	L5	D1	Weight
34.722	G3/8" F	R3/8" M	10	22	88	53	11	17	14	42	640 g
34.723	G1/2" F	R1/2" M	13	22	97	53	15	16	19	42	660 g
34.724	G3/4" F	R3/4" M	18	27	111	61	16	19	22	50	1010 g
34.725*	G1" F	R1" M	24	36	123	64	18	23	29	60	1600 g
34.726*	G1 1/4" F	R1 1/4" M	28	38	144	72	20	26	33	70	2090 g
34.727*	G1 1/2" F	R1 1/2" M	36	50	155.5	80.5	20	30	36	85	3620 g

Part No.	G1 (F)	G2 (F)	NW	SW1	L1	L2	L3	L4	D1	Weight
34.732	G3/8" F	G3/8" F	10	22	86	53	17	14	42	670 g
34.733	G1/2" F	G1/2" F	13	27	97	53	16	19	42	650 g
34.734	G3/4" F	G3/4" F	18	32	111	61	19	22	50	1020 g
34.735*	G1" F	G1" F	24	36	118	64	23	29	60	1520 g
34.736*	G1 1/4" F	G1 1/4" F	28	50	137	72	26	33	70	2150 g
34.737*	G1 1/2" F	G1 1/2" F	36	54	149	80.5	30	36	85	3580 g

Legend

M., = metric thrust, ..M = male, F = female, G = gas pipe thrust, R = gas pipe thrust conical, QV = quick connects
SV = profile ring fitting, D = diameter, L = length, NW = nominal width, SW = wrench size

Additional Seal Options available

EPDM (E) or FKM/Viton (V). Please indicate letter of seal material after part number.
Minimum orders apply.