

- ✓ High speed triple bearing system
- ✓ Corrosion resistant
- ✓ Solid construction
- ✓ Long service life
- ✓ Maintenance free



### Application

Thrust and radial forces, high flow, automatic car wash systems, high pressure hose reels

#### TECHNICAL DATA

**Pressure** 275 bar (27.5 MPa)  
**Temperature** 30°C (at 1'000 rpm)  
 120°C (at 30 rpm)  
**RPM** max. 1'000 rpm  
**Body** DGL: brass, nickel plated  
 DGLI: stainless steel  
**Inner part** stainless steel  
**Seal** O-ring NBR  
 (optional: EPDM or FKM)  
**Bearing** 2x radial ball bearings  
 1x thrust ball bearing  
**Throughput medium** pH 3 - 12  
 10 µm filtered  
 20 bar compressed air

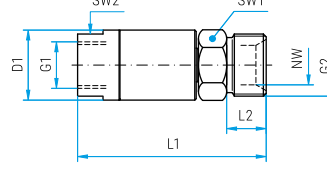
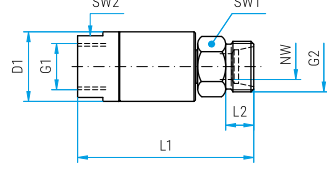
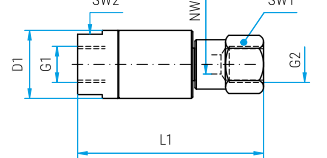
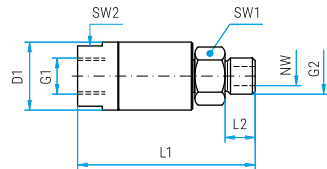
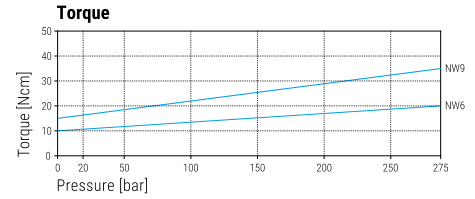
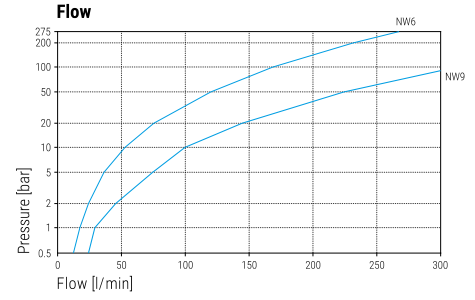

DGL		DGLI								
Part No.	Part No.	G1 (F)	G2 (M)	NW	SW1	SW2	L1	L2	D1	Weight
31.001	31.904	G1/4" F	G1/4" M	6	19	22	65	11	25	170 g
31.003	31.913	G1/4" F	G3/8" M	6	19	22	66	12	25	170 g
31.101	31.914	G3/8" F	G1/4" M	6	19	22	65	11	25	160 g
31.103	31.906	G3/8" F	G3/8" M	6	19	22	66	12	25	160 g
31.603	31.939	G3/8" F	G3/8" M	9	19	22	67	12	25	150 g

Part No.	Part No.	G1 (F)	G2 (F)	NW	SW1	SW2	L1	D1	Weight
31.002	31.907	G1/4" F	G1/4" F	6	19	22	68	25	180 g
31.004	31.928	G1/4" F	G3/8" F	6	22	22	69	25	190 g
31.102	31.932	G3/8" F	G1/4" F	6	19	22	68	25	170 g
31.104	31.908	G3/8" F	G3/8" F	6	22	22	69	25	180 g
31.604	31.940	G3/8" F	G3/8" F	9	22	22	70	25	160 g

Part No.	Part No.	G1 (F)	G2 (SV)	NW	SW1	SW2	L1	L2	D1	Weight
31.005	31.929	G1/4" F	M14x1.5 M	6	17	22	63	10	25	160 g
31.006	31.930	G1/4" F	M16x1.5 M	6	19	22	63	10	25	170 g
31.007	31.912	G1/4" F	M18x1.5 M	6	19	22	63	10	25	170 g
31.105	31.933	G3/8" F	M14x1.5 M	6	17	22	63	10	25	170 g
31.106	31.934	G3/8" F	M16x1.5 M	6	19	22	63	10	25	150 g
31.107	31.935	G3/8" F	M18x1.5 M	6	19	22	63	10	25	160 g
31.607	31.941	G3/8" F	M18x1.5 M	9	19	22	64	10	25	140 g

Part No.	Part No.	G1 (F)	G2 (QV)	NW	SW1	SW2	L1	L2	D1	Weight
31.008	31.931	G1/4" F	M21x1.5 M	6	22	22	67	14	25	180 g
31.009	31.911	G1/4" F	M22x1.5 M	6	22	22	67	14	25	190 g
31.108	31.936	G3/8" F	M21x1.5 M	6	22	22	67	14	25	170 g
31.109	31.937	G3/8" F	M22x1.5 M	6	22	22	67	14	25	180 g

33.910	Seal kit NW 6
--------	---------------

Legend

M., = metric thrust, ..M = male, F = female, G = gas pipe thrust, R = gas pipe thrust conical, QV = quick connects  
 SV = profile ring fitting, D = diameter, L = length, NW = nominal width, SW = wrench size

Additional Seal Options available

EPDM (E) or FKM/Viton (V). Please indicate letter of seal material after part number.  
 Minimum orders apply.