

- ✓ Slide or dual bearing systems
- ✓ Stainless steel
- ✓ Maintenance free

### Application

Ceiling boom, high pressure hose reels, high pressure cleaner

#### TECHNICAL DATA

**Pressure** 275 bar (27.5 MPa)  
**Temperature** 120°C  
**RPM** see chart (max. RPM)

**Body** brass, nickel plated

**Inner part** stainless steel  
**Seal** O-ring NBR  
 (optional: EPDM or FKM)

**Bearing** WDB: sliding bearing  
 WDBL: 2x radial ball bearings  
 WDBS: 2x radial ball bearings

**Throughput medium** pH 3 - 12  
 10 µm filtered  
 20 bar compressed air

#### Flow

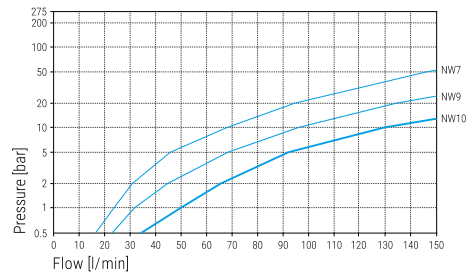

#### Torque

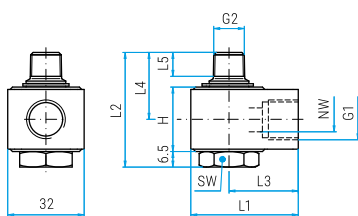
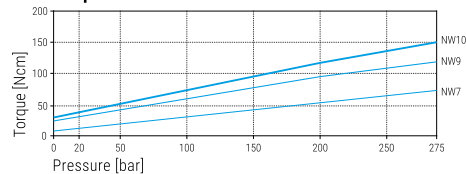

#### WDB

Part No.	G1 (F)	G2 (M)	NW	H	L1	L2	L3	L4	L5	SW	max. RPM	Weight
43.201	G1/4" F	R1/4" M	7	27	45	48	29	28	10	22	30	280 g
43.202	G3/8" F	R3/8" M	9	27	45	49	29	29	11	22	30	260 g
43.209*	G1/4" F	G1/4" M	7	27	45	45	29	25	11	22	30	270 g

\* without snap ring, for Mosmatic ceiling boom

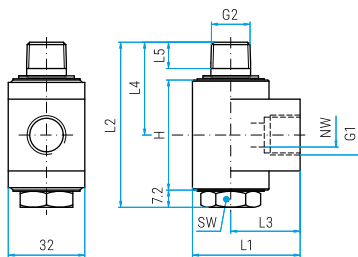

#### WDBL (with radial ball bearings)

Part No.	G1 (F)	G2 (M)	NW	H	L1	L2	L3	L4	L5	SW	max. RPM	Weight
43.212	G3/8" F	R3/8" M	10	46	45	69	29	39	11	22	200	440 g

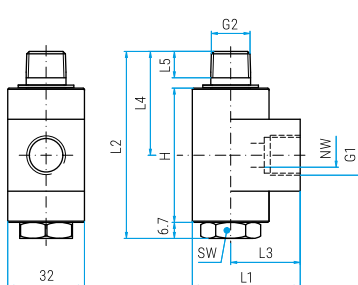

#### WDBS (with radial ball bearings and protection plate)

Part No.	G1 (F)	G2 (M)	NW	H	L1	L2	L3	L4	L5	SW	max. RPM	Weight
43.222	G3/8" F	R3/8" M	10	56	45	78	29	44	11	22	200	520 g

43.904	Seal kit
--------	----------

#### Legend

M.. = metric thrust, ..M = male, F = female, G = gas pipe thrust, R = gas pipe thrust conical, QV = quick connects  
 SV = profile ring fitting, D = diameter, L = length, NW = nominal width, SW = wrench size

#### Additional Seal Options available

EPDM (E) or FKM/Viton (V). Please indicate letter of seal material after part number. Minimum orders apply.