

A heavy duty

RAL 3002 5012 7040

GALVANIZED AND POWDER COATED STRUCTURE / STRUTTURA ZINCATA E VERNICIATA

ø 410 mm
drum/tamburo

4R Optional 4-rollers hose guide
Guida tubo a 4 rulli opzionale

optional page 80-83
INLET HOSE

ACS15

ASG15R

P38AV

 II 2G/D
optional



4R - Optional 4-rollers hose guide. Ordering the version indicating the hose reel code followed by "4R"
4R - Guida tubo a 4 rulli opzionale. Ordinare la versione indicando il codice dell'avvolgitubo seguito da "4R"



EN Automatic hose reels suitable for the distribution of fluids at different pressure and temperature conditions. The parts in contact with the fluid have metal details and high-quality gaskets. The hose-guide support can be mounted in two different positions according to the hose reel installation (pos. A-B). Optional: connection hose, revolving stand, 4-rollers hose-guide, fixing bracket.

FR Enrouleurs automatiques utilisés pour distribuer des fluides à différentes pressions et températures. Composants en contact avec le fluide constitués de pièces métalliques et de joints de haute qualité. Support guide-tuyau applicable en 2 positions différentes pour permettre l'installation souhaitée (pos.

A-B). En option: tuyau de connexion, support pivotant, guide tuyau 4 rouleaux, contre-étrier de fixation.

DE Schlauchaufroller zur Abgabe von versch. Flüssigkeiten untersch. Betriebstemperaturen und -drücke. Teile mit Kontakt von Flüssigkeiten aus spez. Metallen und Dichtungen hoher Qualität. Wandbefestigung für 2 versch. Positionen (s.Abb. A-B). Optional: Verbindungsschlauch, Schwenkkonsole, Schlauchführung mit 4 Rollen und Wandbefestigung.

ES Enrolladores automáticos preparados para distribuir fluidos con diversas condiciones de presión y temperatura. Componentes en

contacto con el fluido constituidos por partes metálicas y guarniciones de alta calidad. Soporte guía manguera aplicable en dos diversas posiciones para permitir la instalación deseada (pos. A-B). Opcional: manguera de conexión, soporte giratorio, guía de manguera de 4 rodillos, sujeción para fijación.

IT Avvolgitubo automatici adatti per distribuire fluidi a diverse pressioni e temperature. Parti a contatto con il fluido costituite da particolari metallici e guarnizioni di elevata qualità. Supporto guidatubo applicabile in due diverse posizioni per consentire l'installazione desiderata (pos. A-B). Optional: tubo di collegamento, supporto girevole, guidatubo a 4 rulli, controstaffa di fissaggio.

Dimensions (mm) / Dimensioni (mm)

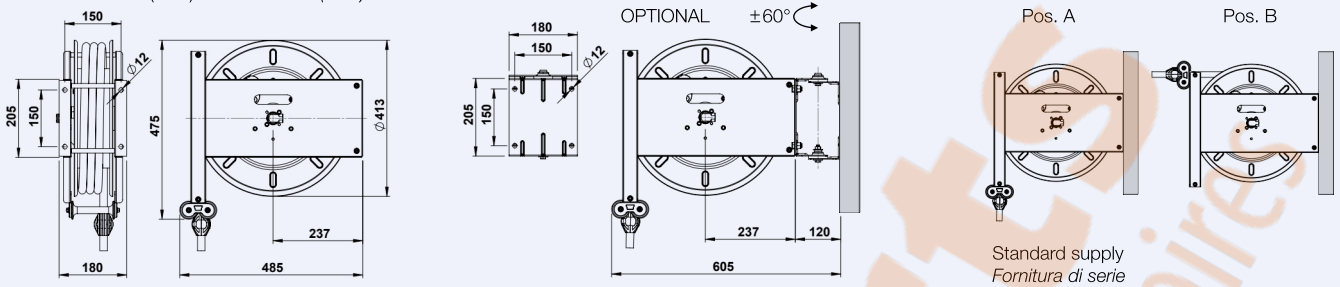

Standard supply
Fornitura di serie

Hose reels model A without hose / Avvolgitubo modello A senza tubo

Fluid Fluido	Max. pressure Pressione max.	Code Codice	Inlet (Bsp) Entrata (Gas)	Outlet (Bsp) Uscita (Gas)	Capacity Capacità	Weight (kg) Peso (kg)	ATEX (optional)
Air/Aria Water/Acqua Oil/Olio	60 Bar/840 PSI	A603815ST	3/8" F	3/8" M	15 m/50 ft	15,5	•
		A601215ST	1/2" M	1/2" M	15 m/50 ft	15,5	•
Air/Aria	18 Bar/250 PSI	A183825ST	3/8" F	3/8" M	(ext. Ø14) 25 m/80ft (ext. Ø17) 20 m/65ft	15,5	•
Grease/Grasso	400 Bar/5600 PSI	A4G1415ST	1/4" F	1/4" M	15 m/50 ft	15,5	•
Water/Acqua 150°C	400 Bar/5600 PSI	A4H3815ST	3/8" F	3/8" M	15 m/50 ft	15,5	•
		*A4H3815STMX	3/8" F	3/8" M	15 m/50 ft	15,5	•

* With stainless steel swivel and shaft / Con giunto e mozzo in acciaio inox

Hose reels model A with hose / Avvolgitubo modello A completi di tubo

Fluid Fluido	Pressure - Hose Pressione - Tubo	Code Codice	Inlet (Bsp) Entrata (Gas)	Outlet (Bsp) Uscita (Gas)	Hose diam. Tubo diam.	Hose length Lungh. Tubo	Weight (kg) Peso (kg)	Inlet hose Tubo entrata	ATEX (optional)
Air/Aria Water/Acqua	18 Bar/250 PSI Rubber/Gomma	A180810	3/8" F	3/8" M	8 x 14	10 m/32 ft	18	TC08005	
		A180815	3/8" F	3/8" M	8 x 14	15 m/50 ft	18	TC08005	•
		A180820	3/8" F	3/8" M	8 x 14	20 m/65 ft	19	TC08005	•
		A181010	3/8" F	3/8" M	10 x 17	10 m/32 ft	18	TC10005	
		A181015	3/8" F	3/8" M	10 x 17	15 m/50 ft	19	TC10005	•
		A181020	3/8" F	3/8" M	10 x 17	20 m/65 ft	20	TC10005	•
		A181310	1/2" M	1/2" M	13 x 20	10 m/32 ft	19	TC13005	
Air/Aria	20 Bar/280 PSI Polyurethane/ Poliuretano	A181315	1/2" M	1/2" M	13 x 20	15 m/50 ft	20	TC13005	•
		A200820PU	3/8" F	3/8" M	8 x 12	20 m/65 ft	18	TC08005PU	
		A201020PU	3/8" F	3/8" M	10 x 14	20 m/65 ft	18	TC10005PU	
		A201025PU	3/8" F	3/8" M	10 x 14	25 m/80 ft	18	TC10005PU	
Oil/Olio	60 Bar/840 PSI 1SC Rubber/Gomma	A201315PU	1/2" F	1/2" M	13 x 18	15 m/50 ft	18	TC13005PU	
		A603810	3/8" F	3/8" M	3/8"	10 m/32 ft	19	TC38005	
		A603815	3/8" F	3/8" M	3/8"	15 m/50 ft	20	TC38005	•
		A601210	1/2" M	1/2" M	1/2"	10 m/32 ft	19	TC12005	
Grease Grasso	400 Bar/5600 PSI 2SN Rubber/Gomma	A601215	1/2" M	1/2" M	1/2"	15 m/50 ft	21	TC12005	•
		A4G1410	1/4" F	1/4" M	1/4"	10 m/32 ft	19	TC14005	
Water Acqua 150°C	250 Bar/3500 PSI 1SC Hydro blue	A4G1415	1/4" F	1/4" M	1/4"	15 m/50 ft	21	TC14005	•
		A2H3815	3/8" F	3/8" M	3/8"	15 m/50 ft	21	TC38005H	
	400 Bar/5600 PSI 2SC Hydro blue	A4H3810	3/8" F	3/8" M	3/8"	10 m/32 ft	20	TC38005H	
		A4H3815	3/8" F	3/8" M	3/8"	15 m/50 ft	22	TC38005H	•
		A4H5115	3/8" F	3/8" M	5/16"	15 m/50 ft	21	TC38005H	•