

26.1320.00 SW90 Giunto gir. 90° inox G1/2 MF

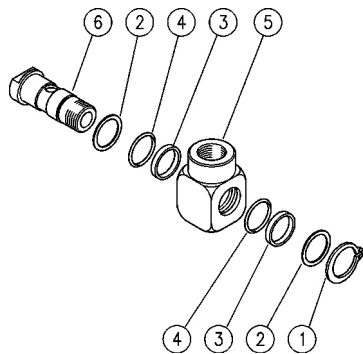

Pos.	Codice	Descrizione	Q.tà	K1	K2	K3	K4	
1	10.1020.05	An. elast. E 20 inox	1					10
2	14.4060.22	Rosetta 22,3x28x1 mm inox	2	•				10
3	10.2067.00	Anello di tenuta 22x25,5x4,1mm	2	•				10
4	10.3242.10	An.OR 3,53x23,4 mm Vi 70	2	•				10
5	26.1321.51	Corpo SW90 G1/2F inox	1					2
6	26.1322.51	Vite forata G1/2 M inox	1					3

Kit	Codice	Descrizione	
K1	26.1325.24	Kit ric. Sw90-inox 3x1pz.	1



26.1320.00 SW90 Swivel 90°, sst, 1/2 MF Bsp

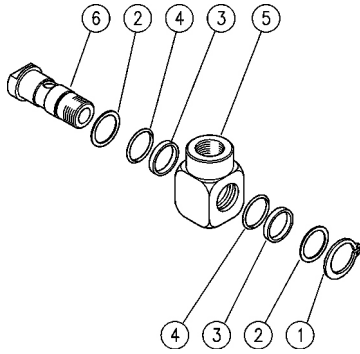

Pos.	P/N	Description	Q.ty	K1	K2	K3	K4	
1	10.1020.05	Snap ring, E 20 Sst.	1					10
2	14.4060.22	Washer, 22,3x28x1 mm Sst.	2	•				10
3	10.2067.00	Seal ring, 22x25,5x4,1 mm	2	•				10
4	10.3242.10	O-ring, 3,53x23,4 mm Vi 70	2	•				10
5	26.1321.51	Housing -SW90, 1/2F Bsp Sst.	1					2
6	26.1322.51	Pierced screw, 1/2M Bsp Sst.	1					3

Kit	P/N	Description	
K1	26.1325.24	Spares kit -Sw90,-Sst. 3x1pcs.	1



Altec
 hogedrukkonderdelen & accessoires

Altec Parts
gedrukkonderdelen & accessoires

P.A. SpA EQUIPAGGIAMENTI TECNICI DEL LAVAGGIO

Via Milano, 13 42048 Rubiera - (RE) ITALY

Tel +39 0522 623611 (ric aut) - Fax +39 0522 629600

Info@pa-etl.it - www.pa-etl.it

**COMPANY WITH
QUALITY SYSTEM
CERTIFIED BY DNV**

= ISO 9001 =