

SERIE 47

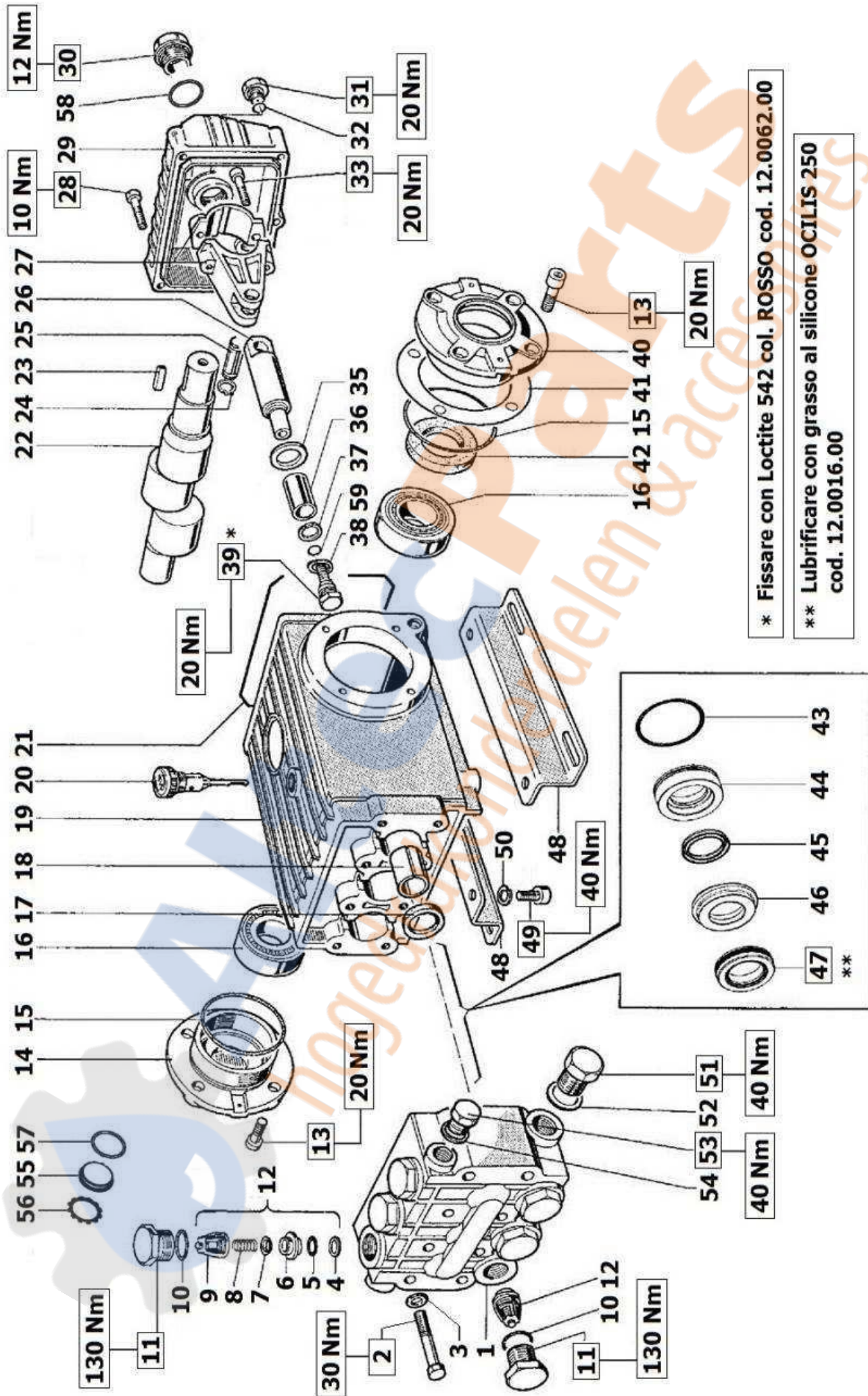

\* Fissare con Loctite 542 col. ROSSO cod. 12.0062.00

\*\* Lubrificare con grasso al silicone OCILIS 250 cod. 12.0016.00

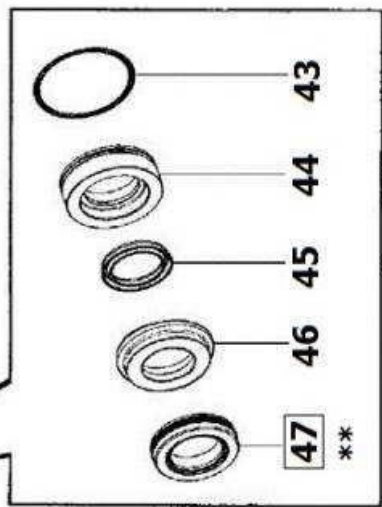

DIS. COD. 47.9521.00

**KIT RICAMBI - SPARE KITS**

<b>VHT4715 - VHT4718 VHT4721 - VHT4723</b>	
--	--

KIT Nr.	KIT 2	KIT 3	KIT 202	KIT 367	KIT 368	KIT 369	KIT 370
Posizioni include Positions included	17	42	45 - 47	10 - 11	35 - 37 38 - 39 59	43 - 44 45 - 46 47	4 - 5 6 - 7 8 - 9 (12)
Nr. Pcs.	3	2	3	6	3	1	6

POS	COD.	DESCRIZIONE - DESCRIPTION - KIT	NR
1	47.1209.41	Testata D. 22	1
2	99.3206.00	Vite M8x70 UNI 5737	8
3	96.7020.00	Rosetta D. 8.4x15.0x1.5	8
4	90.5105.00	Anello antiest. D. 17.4x21.9x1.8	370
5	90.3401.00	An. ten. D. 17.1x22.3x1.8 HNBR	370
6	36.2003.66	Sede valvola	370
7	36.2001.76	Valvola sferica	370
8	94.7376.00	Molla Dm. 9.4x14.8 INOX	370
9	36.2002.51	Guida valvola	370
10	90.3847.50	OR D. 20.24x2.62 HNBR 90SH 3081	367
11	98.2222.00	Tappo M24x2x16.5	367
12	36.7261.01	Gr. valvola aspirazione / mandata	370
13	99.3039.00	Vite M8x16 UNI 5931	8
14	47.1512.22	Coperchio cuscinetto lato spia	1
15	90.3913.00	OR D. 67.95x2.62 NBR 70SH 3268	2
16	91.8378.00	Cuscinetto a rulli	2
17	90.1625.00	Anello rad. D. 22.0x32.0x6.5	2
18	90.9126.00	Boccola D. 22.0x25.0x30.0	3
19	47.0100.22	Carter pompa	1
20	98.2106.00	Tappo con asta G 3/8"x64	1
21	90.3922.00	OR D. 133.02x2.62 NBR 70SH 3525	1
22	47.0219.35	Albero ecc. C.10 - VHT4715	1
	47.0218.35	Albero ecc. C.12 - VHT4718	
	47.0221.35	Albero ecc. C.14 - VHT4721	
	47.0224.35	Albero ecc. C.15 - VHT4723	
23	91.4892.00	Linguetta 9.0x7.0x35.0	1
24	90.0557.00	Anello d'arresto A12	6
25	97.7380.00	Spinotto D. 13.0x35.5	3

POS	COD.	DESCRIZIONE - DESCRIPTION - KIT	NR
26	47.0504.66	Guida pistone	3
27	47.0300.01	Biella completa	3
28	99.1912.00	Vite M6x30 UNI 5931	5
29	47.1601.22	Coperchio posteriore	1
30	47.2213.01	Gr. spia livello olio G 3/4"	1
31	98.2042.50	Tappo G 1/4"x9 TE17 - Zinc.	1
32	90.3585.00	OR D. 10.82x1.78 NBR 70SH 2043	1
33	99.3099.00	Vite M8x35 UNI 5931	6
35	96.7286.00	Rosetta D. 14.0x280.x0.5	368
36	47.0405.09	Pistone D. 22	3
37	90.5067.00	Anello antiest. D. 11.0x14.0x1.5	368
38	96.7280.00	Rosetta D. 14.0x18.5x0.5	368
39	47.2195.66	Vite fissaggio pistone	368
40	47.1510.22	Coperchio cuscinetto lato PTO	1
41	97.5678.00	Spessore D. 74.5x104.0x0.1	-
	97.5680.00	Spessore D. 74.5x104.0x0.3	
42	90.1648.00	Anello rad. D. 30.0x55.0x7.0	3
43	90.3616.50	OR D. 34.65x1.78 HNBR 70SH 2137	369
44	47.0814.70	Anello di fondo D. 22	369
45	90.2300.00	Anello ten. alt. D. 22x28.15 LP 202-369	3
46	47.2175.70	Anello intermedio D. 22	369
47	90.2310.00	Anello ten. alt. D. 22.0x35.0x9.0	202-369
48	47.2000.74	Piede pompa	2
49	99.3644.00	Vite M10x18 UNI 5931	4
50	96.7106.00	Rosetta D. 10.2x16.0x2.5	4
51	98.2179.00	Tappo G 1/2"x10	1
52	96.7514.00	Rosetta D. 21.5x27.0x1.5	1