

SERIE 66

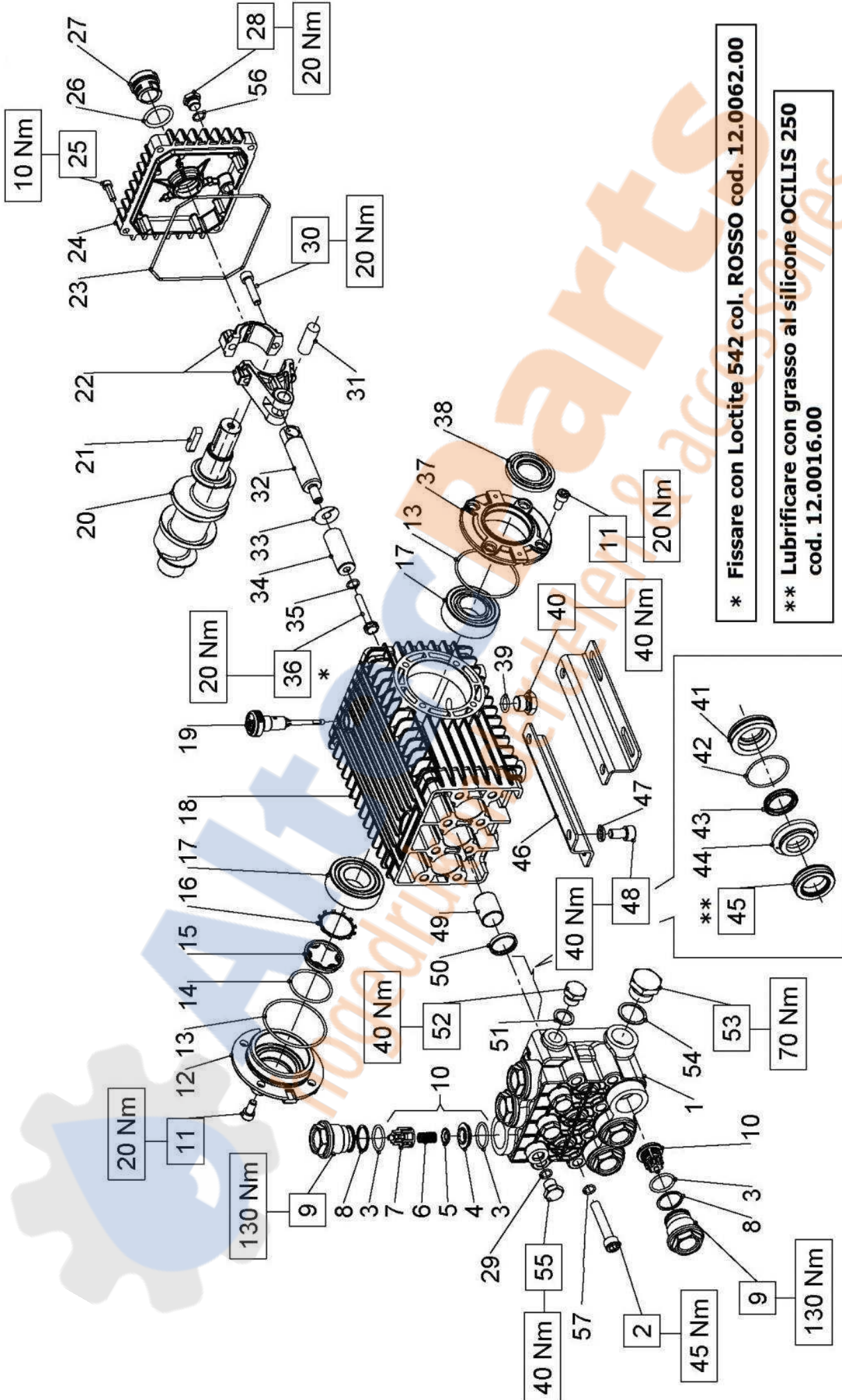

DIS. COD. 66.9502.00

KIT RICAMBI - SPARE KITS

KIT RICAMBI - SPARE KITS				PISTONE - PISTON D. 20		PISTONE - PISTON D. 22		PISTONE - PISTON D. 24	
KIT Nr.	KIT 2	KIT 3	KIT 375	KIT 206	KIT 376	KIT 208	KIT 377	KIT 210	KIT 378
Posizioni include Positions included	50	38	3 - 4 5 - 6 7 (10)	43 - 45	41 - 42 43 - 44 45	43 - 45	41 - 42 43 - 44 45	43 - 45	41 - 42 43 - 44 45
Nr. Pcs.	3	2	6	3	1	3	1	3	1

**VHT6628 - VHT6639
VHT6646 - VHT6635**

PISTONE - PISTON D. 20		PISTONE - PISTON D. 22	
VHT6628 - VHT6635	VHT6639		
PISTONE - PISTON D. 24		VHT6646	

POS	COD.	DESCRIZIONE - DESCRIPTION - KIT	NR
1	66.1206.41 66.1207.41 66.1208.41	Testata pompa D. 20 Testata pompa D. 22 Testata pompa D. 24	1
2	99.3801.00	Vite M10x90 UNI 5931	8
3	90.3857.50	OR D. 23.81x2.62 HNBR 70 SH 132 375	12
4	36.2033.66	Sede valvola	6
5	36.2034.76	Valvola sferica	6
6	94.7388.00	Molla Dm. 10.0x18.5	6
7	36.2035.51	Guida valvola	6
8	90.5165.00	Anello antiest. D. 24.7x29.0x1.5	6
9	66.1303.41	Tappo M32x1.5x29.5	6
10	36.7263.01	Gr. valvola aspirazione / mandata	375
11	99.3039.00	Vite M8x16 UNI 5931	8
12	47.1512.22	Coperchio cuscinetto lato spia	1
13	90.3913.00	OR D. 67.95x2.62 NBR 70SH 3268	2
14	90.3877.00	OR D. 39.34x2.62 NBR 70SH 3156	1
15	70.2118.01	Spia livello olio	1
16	90.0756.00	Anello d'arresto ZJ45	1
17	91.8380.00	Cuscinetto a rulli	2
18	66.0100.22	Carter pompa	1
19	98.2106.00	Tappo con asta G 3/8"x64	1
20	66.0200.35 66.0204.35	Albero ecc. C.19 - VHT6628 Albero ecc. C.21 - VHT6639 VHT6646 VHT6635	1

POS	COD.	DESCRIZIONE - DESCRIPTION - KIT	NR
21	91.4892.00	Linguetta 9.0x7.0x35.0	1
22	66.0300.01	Biella completa	3
23	90.3922.00	OR D. 133.02x2.62 NBR 70SH 3525	1
24	66.1600.22	Coperchio posteriore	1
25	99.1884.00	Vite M6x20 UNI 5931	4
26	90.4051.00	OR D. 26.58x3.53 NBR 70SH 4106	1
27	63.2100.51	Spia livello olio	1
28	98.2042.50	Tappo G 1/4"x9 TE17 - Zinc.	1
29	90.3585.50	OR D. 10.82x1.78 HNBR 70SH 2043	3
30	99.3099.00	Vite serraggio biella	6
31	97.7405.00	Spinotto D. 14x39	3
32	66.0500.66	Guida pistone	3
33	96.7101.00	Rosetta D. 10.0x28.0x0.5	3
34	66.0400.09 66.0401.09 66.0404.09	Pistone D. 20x54 Pistone D. 22x54 Pistone D. 24x54	3
35	90.3584.50	OR D. 10.82x1.78 HNBR 90 SH 2043	3
36	66.2195.66	Vite fissaggio pistone	3
37	47.1510.22	Coperchio cuscinetto lato PTO	1
38	90.1648.00	Anello rad. D. 30.0x55.0x7.0	3
39	90.3833.00	OR D. 13.95x2.62 NBR 70SH 3056	1
40	98.2100.50	Tappo G 3/8"x13 TE22 - Zinc.	1
41	66.0812.70 66.0813.70 66.0814.70	Anello di fondo D. 20 Anello di fondo D. 22 Anello di fondo D. 24	376 377 378
42	90.3616.50	OR D. 34.65x1.78 HNBR 70SH 2137 376 377 378	3
43	90.2250.00 90.2300.00 90.2350.00	Anello tenuta D. 20x26.15 LP Anello tenuta D. 22x28.15 LP Anello tenuta D. 24x30.15 LP	206 376 208 377 210 378